



Fixtures



Drapery Supports



Phone Systems



Hardware



Zipline Anchors

Hollow Wall Anchoring Systems

 **Powers**
FASTENING INNOVATIONS

Zip-All • Zip-It® • Zip-It Jr.

Wallboard Anchor

PRODUCT DESCRIPTION

The Zip-It and Zip-It Jr. anchors are one-piece self drilling anchors designed for use in hollow gypsum wallboard. They are available in both engineered Nylon and Zamac alloy for use with No. 6, 8 or 10 screw in 3/8" to 1" thick wallboard.

FEATURES AND BENEFITS

The Zip-It and Zip-It Jr. are ideal for mounting electrical fixtures, fastening drapery supports, installing phone systems, and miscellaneous hardware. It comes packaged with or without screws.

INSTALLATION SPECIFICATIONS

Dimensions	Zinc Zip-It	Zinc Zip-It Jr.	Zip-All
Collar Size (in.)	0.562	0.46	0.605
Screw Size Range (#)	#8-#10	#6-#8	#6-#8
Thread Length (in.)	1	3/4	1/2
Point Length (in.)	0.3	0.3	0.43
Anchor Length (in.)	1-1/4	1	1
Typ. Screw Engagement	3/4	3/4	1/2

INSTALLATION GUIDELINES

Inset either No.2 or No.3 Phillips driver bit into the recess of the Zip®-Line anchor head. Use a manual screwdriver or a low rpm battery powered electric screw gun.

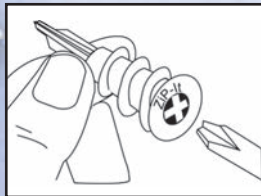

Push the Zip®-Line anchor into the surface of the wallboard until the two cutting blades penetrate the surface. Using gentle forward pressure, rotate the Zip®-Line until the collar sets flush to the surface of the wall.

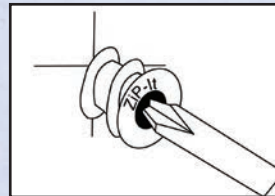

Put the fixture in place, insert the screw and tighten until it feels secure.

As the screw is threaded into the nylon versions, the point will expand resulting in increased load capacity in thicker wallboard.

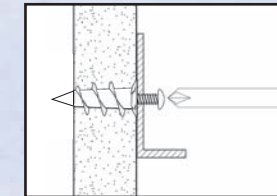

ANCHOR MATERIALS

Engineered Nylon or Zamac Alloy

ANCHOR SIZE RANGE (TYP.)

Use with #6-10 size screws

SUITABLE BASE MATERIALS

3/8" to 1" wallboard

Note: Pre-drill hole if difficulty is encountered during installation of the Zip-It. In very hard wallboard or double-board construction, use 1/4" diameter drill bit. In solid plaster wall use 7/16" diameter drill bit (HSS or Carbide). Job site tests are recommended when pre-drilling holes.

Note: When using an electric screw gun for application, set clutch and use slow speed (do not exceed approximately 300-400 rpm).



Zip-All • Zip-It® • Zip-It Jr.

Zip-All



Drywall

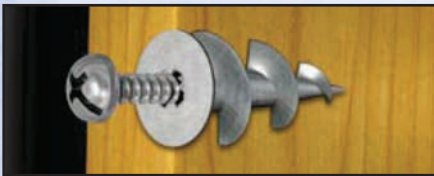

Wood Stud

Recommended Holding Strengths

Base Material	Holds Up to (llbs.)	Pre-Drilled Hole
1/2" Drywall	50	Not Needed
1/2 Drywall/ wood stu	100	Not Needed
Wood	150	3/8" ANSI

Zip-It®



Drywall

Recommended Holding Strengths / Zip-It

Base Material	Holds Up to (llbs.)	Pre-Drilled Hole
1/2" Drywall	70	Not Needed

Recommended Holding Strengths / Zip-It Jr.

Base Material	Holds Up to (llbs.)	Pre-Drilled Hole
1/2" Drywall	50	Not Needed

Zip-All • Zip-It® • Zip-It Jr.

ORDERING INFORMATION

Zip-All

Cat No.	Wall Thickness	Description	Std. Box	Std. Carton	Wt./100
2296	3/8" to 1"	Zinc - no screws	100	1,000	1/2
2297	3/8" to 1"	Zinc - with screws	100	1,000	1-1/4

Nylon Zip-It

Cat No.	Wall Thickness	Description	Std. Box	Std. Carton	Wt./100
2345	3/8" to 1"	Nylon - no screws	100	1,000	1/2
2348	3/8" to 1"	Nylon - with screws	100	1,000	1-1/4
2355	3/8" to 1"	Nylon Master Cart. - no screws	-	5,000	1/2

Zinc Zip-It

Cat No.	Wall Thickness	Description	Std. Box	Std. Carton	Wt./100
2346Z	3/8" to 1"	Zinc - no screws	100	1,000	2
2349Z	3/8" to 1"	Zinc - with screws	100	1,000	2-1/2
2356Z	3/8" to 1"	Zinc Master Cart. - no screws	-	5,000	1-3/4

Zip-It Kits

Cat No.	Material	Description	Std. Box	Std. Carton	Wt./100
2368	Nylon	50 Anchor, No. 8 x 1" Screws, & No. 2 Phillips Driver Bit	1	10	7
2369	Zinc	50 Anchor, No. 8 x 1" Screws, & No. 2 Phillips Driver Bit	1	10	13-1/2

Nylon Zip-It Jr.

Cat No.	Wall Thickness	Description	Std. Box	Std. Carton	Wt./100
2350	3/8" to 5/8"	Nylon - no screws	100	1,000	1/4
2351	3/8" to 5/8"	Nylon - with screws	100	1,000	3/4
2365	3/8" to 5/8"	Nylon Master Cart. - no screws	-	5,000	

Zinc Zip-It Jr.

Cat No.	Wall Thickness	Description	Std. Box	Std. Carton	Wt./100
2362Z	3/8" to 5/8"	Zinc - no screws	100	1,000	1
2364Z	3/8" to 5/8"	Zinc - with screws	100	1,000	3
2363Z	3/8" to 5/8"	Zinc Master Cart. - no screws	-	5,000	1

Zip-It Jr. Kits

Cat No.	Material	Description	Std. Box	Std. Carton	Wt./100
2367	Nylon	50 Anchor, No. 8 x 1" Screws, & No. 2 Phillips Driver Bit	1	10	7

Note: To select the proper screw length required, determine the thickness of the fixture, including any spacers or shims and add 3/4".

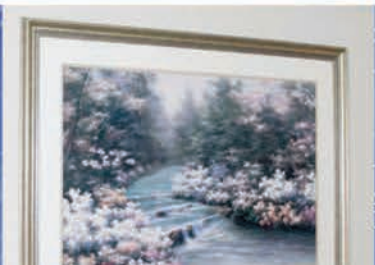

Zip-Toggle®

Hollow Wall Anchor

PRODUCT DESCRIPTION

The Zip-Toggle is a self drilling hollow gypsum wallboard anchor designed to provide superior performance without the need to pre-drill larger diameter holes. The Zip-Toggle is packaged with its own No. 6 x 2" lubricated screw.

FEATURES AND BENEFITS

- Self drills and uses a smaller hole versus toggle bolts
- Fast and easy installation – approximately 5 times faster than toggles
- Heavy duty toggle design works in 3/8" to 5/8" wallboard
- Fastens fixtures up to 3/4" thick

MATERIAL SPECIFICATIONS

Anchor Component	Component Material
Fastener Body	Zinc
Screw	Carbon Steel - ANSI 18.6.4
Screw Plating	ASTM B633, SC1, Type III (Zn/Fe 5)

INSTALLATION SPECIFICATIONS

Recommended Size	No. 6 x 2" (lubricated)
Threaded Length (in.)	21/64
Point Length (in.)	5/8
Anchor Length (in.)	2-1/8

Installation Guidelines

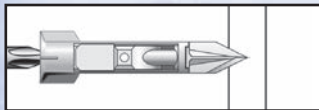

Using a manual or low RPM battery powered electric screwdriver, insert a No.2 Phillips driver bit into the recess of the anchor and press the tip of the anchor into the wallboard until the cutting blades penetrate the surface.

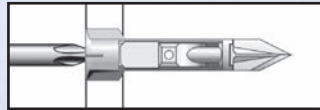

Using gentle forward pressure, press the anchor further into the wall board until the collar is set flush with the surface of the wallboard.

ORDERING INFORMATION

Zip-Toggle

Cat. No.	Description	Std. Box	Std. Ctn
2295	Zinc w/ No.6 x 2" Screws	50	250

© 2008 Powers Fasteners, Inc. All Rights Reserved. Zip-Toggle is a trademark of Powers Fasteners, Inc.

Position the fixture and insert a No. 6 x 2" screw (packaged with the anchor). Press the screw into the anchor until the toggle portion is opened.

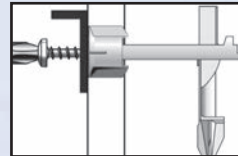

Tighten the screw until it feels secure with the toggle portion

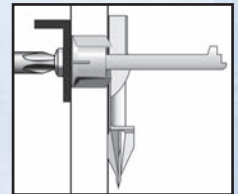

seated against the back of the wallboard. Do not over tighten. Note: Use only a No. 6 x 2" lubricated screw as packaged with the anchor.

RECOMMENDED HOLDING STRENGTH

Anchor Size	1/2" Drywall/ Holds Up to (lbs.)	5/8" Drywall/ Holds Up to (lbs.)
# 6 x 2" Screw	150	180



Easier to use than a Toggle Bolt!



Sharkie

Expansion Wall Anchor



PRODUCT DESCRIPTION

The Sharkie wall anchor is engineered for strength - the screw extrudes and compresses the anchor polymer into the wall under tremendous pressure. The anchor molds and conforms exactly to the surface of the hole. All of the forces supported by the screw are transmitted outwardly 360° providing greater holding power by distributing the force over the maximum area possible.

GENERAL APPLICATIONS AND USES

- Electrical equipment
- Telephone equipment
- Towel dispensers
- Plumbing fixtures
- Fire extinguishers
- Soap dispensers
- Light machinery
- Shelving
- Alarms
- Awnings
- Antennae
- Framing
- Signs
- Storm shutters
- Lighting fixtures
- Cabinets
- Circuit breakers
- Window frames
- RTA furniture
- HVAC equipment
- Bathroom partitions

FEATURES AND BENEFITS

- Can be installed through the fixture with a screw gun—anti-rotation fins and unique head design prevent sinking and spinning.
- Work in almost any building material.
- Work with broadest range of screw sizes for highest holding power without cracking wall.
- Set instantly, unlike so-called chemical anchors. “Molding” action bonds anchor to wall.
- Specially formulated corrosion-proof polymer absorbs shock and vibration
- Non-corrodible, non-magnetic, and non-conductive

ANCHOR MATERIALS

Engineered Nylon

ANCHOR SIZE RANGE (TYP.)

Flange Ranges 4-10, 6-12, 8-14

SUITABLE BASE MATERIALS

Concrete	Brick
Cinder Block	Wood
Masonry	Ceramic Tile
Plaster	Stone
Stucco	Aerated Concrete
Flakeboard	Drywall

*To ensure maximum holding and accommodate anchor elongation, hole depth should be at least two anchor diameters more than the anchor length. Anchor should be fully threaded by screws as shown. Unlike other plastic anchors, the fins on the sharkie anchor prevent the anchor from sinking into the hole and spinning on installation.

ORDERING INFORMATION

Cat. No.	Description	Std. Box	Std. Ctn
7580	Sharkie Flange 4-10	100	1,000
7582	Sharkie Flange 6-12	100	1,000
7584	Sharkie Flange 8-14	100	500

INSTALLATION SPECIFICATIONS*

Dimensions	07580	07582	07584
Drill Diameter (in.)	3/16	1/4	5/16
Screw Size Range (#)	#4-#10	#6-#12	#8-#14
Min. Thread Length (in.)	1-3/16	1-3/8	1-13/16
Anchor Length (in.)	1	1-3/16	1-5/8
Hole Depth Min. (in.)	1-3/8	1-9/16	2
Min. Wall Thickness (in.)	1/4	3/8	1/2
Min. Embedded Thread Length (in.)	1-7/8	2	2-9/16

1. In dry wall, a 10d nail or awl will suffice to make insertion hole for Sharkie Flange 4-10 anchor.
2. For large screws, use 5/16" drill for soft substrate (drywall) and 1/4" drill for very hard substrate (high compression concrete).
3. Total screw length should never exceed hole depth + fixture thickness. In hollow walls, minimum screw length = wall thickness + fixture thickness + 1/4"
4. In high compression strength substrates, screws that are nominally equal in diameter to the anchor can be used for high strength applications.



INSTALLATION GUIDELINES

Solid Base Material

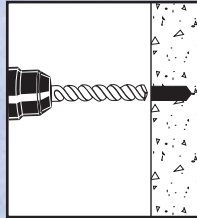

Drill hole into solid wall same diameter as anchor diameter. Minimum hole depth = 2x the length of the anchor.

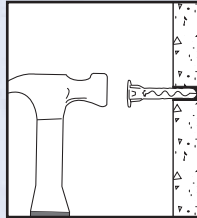

Push in anchor and tap flush to wall with hammer.

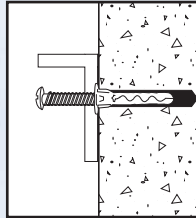

Place item over anchor. Insert screw and tighten flush with item.

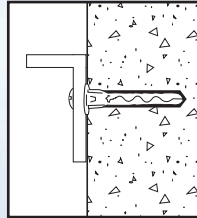

Anchor will extrude up to 2x its original length, sealing the hole and providing highest holding power.

Hollow Base Material

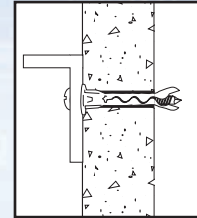

Fins wedge in thick wall.

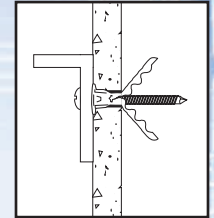

In hollow drywall, fins cut into wall, jaws lever and wedge open.

Note: For best results, use a screw gun for installation in solid walls. If you hit a hidden cavity, the screw opens the anchor and locks securely.

PERFORMANCE DATA

Ultimate Load Capacities in Concrete

Anchor Size	Drill Diameter	Screw Size	4000psi Concrete	
			Tension (lbs.)	Shear (lbs.)
#4-#10	3/16"	#8 sheet metal screw	90	120
		#10 sheet metal screw	90	120
#6-#12	1/4"	#8 sheet metal screw	190	220
		#10 sheet metal screw	190	220
#8-#14	5/16"	#8 sheet metal screw	215	500
		#10 sheet metal screw	215	500

Recommended Holding Strength in Drywall

Anchor Size	Drill Diameter	Screw Size	1/2" Drywall / Hold Up to (lbs.)
#6-#12	1/4"	#8 sheet metal screw	70
		#10 sheet metal screw	70
#8-#14	5/16"	#8 sheet metal screw	70
		#10 sheet metal screw	70

Ultimate Load Capacities in Drywall

Anchor Size	Drill Diameter	Screw Size	1/2" Drywall	
			Tension (lbs.)	Shear (lbs.)
#6-#12	1/4"	#8 sheet metal screw	80	160
		#10 sheet metal screw	80	160
#8-#14	5/16"	#8 sheet metal screw	90	180
		#10 sheet metal screw	90	180

POWERS FASTENERS BRANCH INFORMATION

USA LOCATIONS

CITY	ADDRESS	CONTACT	PHONE	FAX
Alabama	5405 Buford Hwy Suite 410 Norcross, GA 30071-3984	Jeff Hatchett	205-520-6044	678-966-9242
Atlanta	5405 Buford Hwy Suite 410 Norcross, GA 30071-3984	Ryan Raica	678-966-0000	678-966-9242
Boston	2 Powers Lane, Brewster, NY 10509	Jack Armour	800-524-3244	914-576-6483
Charlotte	349 L West Tremont Avenue, Charlotte, NC 28203	Bob Aurisy	704-375-5012	704-376-5517
Chicago	2472 Wisconsin Avenue, Downers Grove, IL 60515	Dan Gilligan	630-960-3156	630-960-3912
Dallas	1300 IH 35 North, Suite #118, Carrollton TX 75006	Matt Henderson	972-506-9258	972-506-9290
Denver	2475 West Second Street #35, Denver, CO 80223	Jared Hemmert	303-922-9202	303-922-9228
Detroit	21600 Wyoming Avenue, Oak Park, MI 48237	Glen Gaskill	248-543-8600	248-543-8601
Florida	2412 Lynx Lane, Orlando, FL 32804	John Christy	813-626-4500	813-626-4545
Houston	13833 North Promenade, Suite 100, Stafford, TX 77477	Vaughn Eshelman	281-491-0351	281-491-0367
Indianapolis	15290 Stony Creek Way, Noblesville, IN 46060	Bill Trainor	317-773-1668	317-773-1690
Kansas City / St Louis	716 East 16th Avenue, North Kansas City, MO 64116	Don James, Jr.	816-472-5038	816-472-5040
Los Angeles	2761 Dow Avenue, Tustin, CA 92780	Trevor Gillespie	714-731-2500	714-731-2566
Maryland	3137-B Penny Drive, Landover, MD 20785	Chris Van Syckle	301-773-1722	301-341-5119
Milwaukee	12020 W. Feerick Street, Milwaukee, WI 53222	Donn Raduenz	414-466-2400	414-466-3993
Minneapolis	351 Wilson Street, NE Minneapolis, MN 55413	Josh Nelson	612-331-3770	612-331-3549
Nashville/Memphis	221 Blanton Avenue, Nashville, TN 37210	Jamie Utley	615-248-2667	615-248-2676
New Orleans	102 Sampson Street, Houston, TX 77003	Cal Zenor	713-228-1524	713-228-1528
New York	2 Powers Lane, Brewster, NY 10509	John Partridge	914-235-6300	914-576-6483
Philadelphia	2 Powers Lane, Brewster, NY 10509	Greg Stephenson	800-524-3244	914-576-6483
Phoenix	3602 E. Southern Ave, Suite 5 Phoenix, AZ 85040	Patrick Stysly	602-431-8024	602-431-8027
Pittsburgh	1360 Island Avenue, McKees Rocks, PA 15136	Bill Dugan	412-771-3010	412-771-9858
Portland	18808 142nd Ave NE, Suite 4A, Woodinville, WA 98072	Jim Swink	360-608-6845	206-762-5817
Rochester	36 Van Auker Blvd., Rochester, NY 14608	Mark Harper	800-524-3244 / 585-529-4188	914-576-6483 / 585-529-5319
Salt Lake City	3120 W. California Ave, Suite E, Salt Lake City, UT 84104	Don Manning	801-466-9428	801-466-3083
San Francisco	28970 Hopkins Street, Suite B+C, Hayward, CA 94545	John O'Brien/Craig Hering	510-293-1500	510-293-1505
Seattle	18808 142nd Ave NE, Suite 4A, Woodinville, WA 98072	Darin Arnold/Jim Swink	206-762-5812	206-762-5817

INTERNATIONAL LOCATIONS

COUNTRY/REGION	ADDRESS	CONTACT	PHONE	FAX
Australia	Factory 3, 205 Abbotts Road, Dandenong, South Victoria 3175	Peter Pratis	+61 3 8787 5888	+61 3 8787 5899
Canada	6950 Edwards Blvd. Mississauga, Ontario L5T 2W2	Mark Russell	905-673-7295	905-673-6490
China	Metropolitan Business Centre, East Nandan Road, Lane 300, No. 9, Room 604 Xuhui District, Shanghai, China 200030	Jake Olsen	+86-21-3363-2880	+86-21-5080-5389
Europe	Westrak 208, 1771 SV Wieringerwerf, Netherlands	Colin Earl	+31 888 769 377	+31 227 594 759
Manitoba	1810 Dublin Avenue Man. Winnipeg, R3H 0H3	Distributor	204-633-0064	204-694-1261
New Zealand	PO Box 302 076 North Harbour Auckland	Clay Sesto	+64 9415 2425	+64 9415 2627
Quebec	721 Meloche Avenue, Dorval, Quebec H9P 2S5	Allan Hill	514-631-4216	514-631-2583

LATIN & CARIBBEAN DISTRIBUTION INQUIRIES

COUNTRY/REGION	ADDRESS	CONTACT	PHONE	FAX
Latin America		Allan Herbert	01150767477749	914-576-6483

LATIN & CARIBBEAN DISTRIBUTION

COUNTRY/REGION	ADDRESS	CONTACT	PHONE	FAX
Brazil	HARD, Rua Dr. Humberto Pinheiro Viera, 150 Lote B, 1 B Distrito Industrial, Joinville, Brazil		55-47-40097209	55-47-40097217
Colombia	Electrogeno, S.A., Carrera 52 #71c-38, Bogota, Colombia		(57) 1 6600 9436	
Costa Rica	Electro Mechanics Supply, La Uruca Contiguo Banco Ntrnl., De Costa Rica Condominio, Horizontal Bodega #9, San Jose, Costa Rica		(506) 2233-2595	
Dominican Republic	Calle Estancia Nueva #17 E Esquina Cul-De-Sac 9, San Geronimo, Santo Domingo	Rodfor Team	809-224-5615	809-472-8640
Ecuador	Acerco Comercial Ecuatoriano S.A., Av. La Prensa N45-14 y Telégrafo 1 – Quito	info@acerocomercial.com	(593-2) 2454 333	(593-2) 2454 455
	Av. Juan Tanco Marengo Km. 1.7 – Guayaquil	info@acerocomercial.com	(593-4) 2683 060	(593-4) 2683 059
Guatemala	Tecnofijaciones, 6 Avenue 8-56 Zona 9, Zona 9, Guatemala	Oscar Lucas Penagos	502-233-4-3478	
Panama	Centro-Industrial, Via Cincuentenario, No. 7910, Ciudad Panama, Panama		(507) 302-8022	
Peru	Powers Peruana SAC, Av. Santa Catalina, 555 La Victoria, Lima 13, Peru (www.powersperuana.com)	Martin Vasquez	(011) 511 265 8500	(011) 511 330 0909
Venezuela	Calle Sucre/Qta. Maudora, #1721 Entre Cec Acosta Y San Ignacio Chacao, Caracas	Distributor	58 212 264 1313	58 212 263 0219
Trinidad - Tobago	Ft. Farfan, 3-5 Ibis Avenue, Ibis Acres, San Juan	Derek Cumming	(868) 674-7896	

Note: The information and data contained within this documentation was current as of April 2013. The information is for marketing purposes only and is subject to change and updates as needed. Powers Fasteners, Inc. reserves the right to change designs and specifications without notice or liability for such changes. Please contact Powers Fasteners for the most current and up to date available information or refer to our website at www.powers.com

Powers Fasteners 2 Powers Lane, Brewster, NY 10509 P: (914) 235-6300 F:(914) 576-6483
Powers Fasteners Canada Ltd. 6950 Edwards Boulevard Mississauga Ontario L5T-2W2 Canada
P: (905) 673-7295 or 1-800-387-3480 F: (905) 673-6490

www.powers.com
Cat. No. 49076 4/13
©2013 Powers Fasteners, Inc.

